



Sunningdale Court Jupps Lane

Worthing, BN12 4TU

Offers over £230,000



Sunningdale Court Jupps Lane Worthing, BN12 4TU

James & James Estate agents are delighted to bring to market this superb two bedroom, second floor, purpose built apartment with balcony.

Situated in favoured south Goring. In brief the accommodation comprises communal entrance with stairs to the second floor, spacious entrance hall with storage cupboards, feature lounge/diner with balcony, two double bedrooms, modern fitted kitchen, and modern bathroom.

Communal gardens surround the property, and in our opinion internal viewing is considered essential to appreciate the overall size and condition of this fantastic apartment.

Situated off Jupps Lane, Sunningdale Court is one of Goring's favoured blocks being ideally situated to the shopping facilities at Aldsworth Parade. Going mainline railway station is close by and busses also serve the area. The beach and Greensward is approximately 1/2 mile distance, and Worthing town centre with it's more comprehensive range of shopping facilities is approximately 3 miles away.

Lease length 189 years
Service charge 1200pa
Council Tax Band B

Communal entrance

Stairs to second floor

Lounge/diner
16'6 x 10'6 (5.03m x 3.20m)





Balcony

Kitchen/breakfast room
10'9 x 7'10 (3.28m x 2.39m)

Bedroom 1
11'2 x 10'10 (3.40m x 3.30m)

Bedroom 2
12'4 x 10'9 (3.76m x 3.28m)

Bathroom

Floor Plan

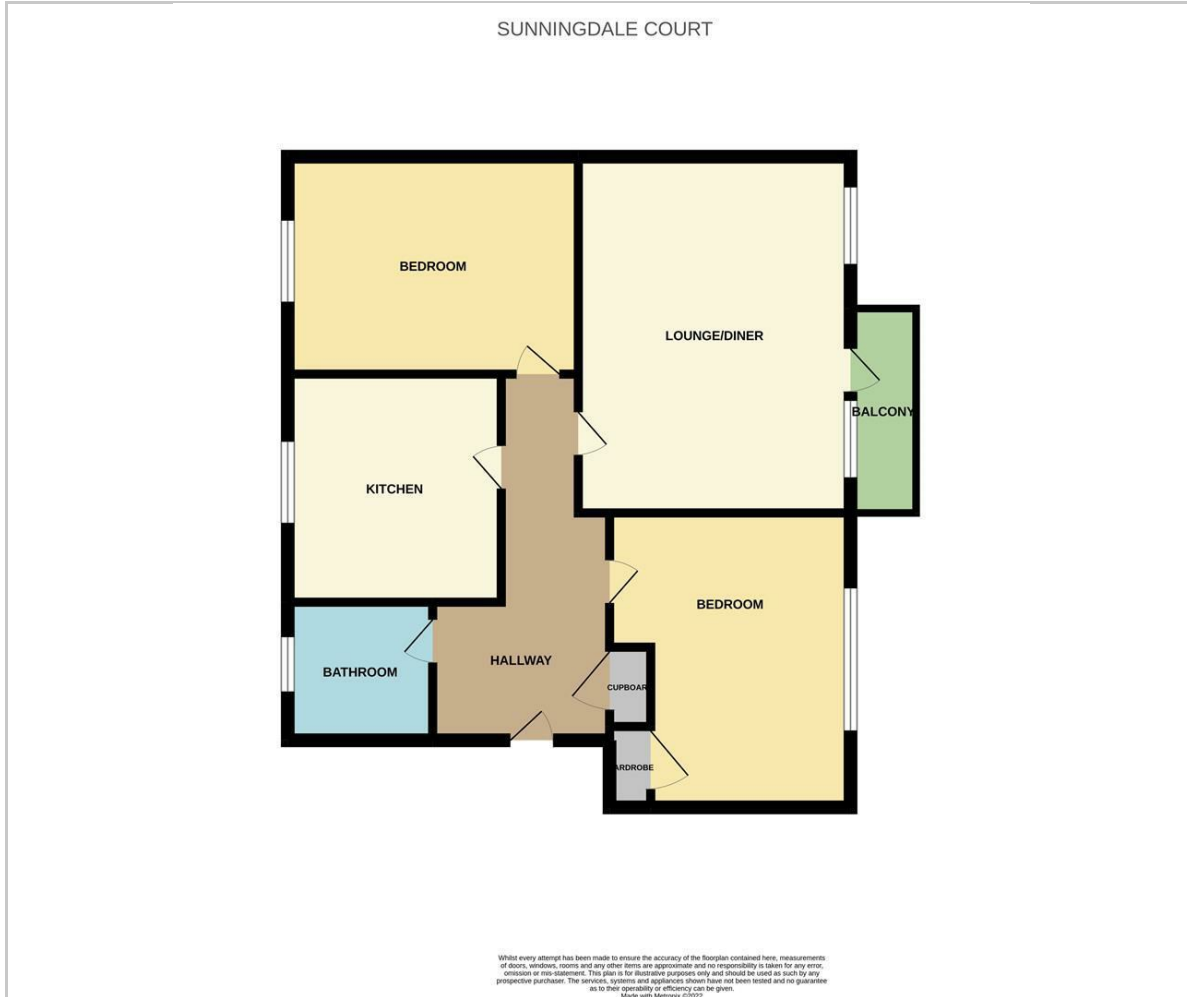

Viewing

Please contact our Worthing Office on 01903 958770 if you wish to arrange a viewing appointment for this property or require further information.

These particulars, whilst believed to be accurate are set out as a general outline only for guidance and do not constitute any part of an offer or contract. Intending purchasers should not rely on them as statements of representation of fact, but must satisfy themselves by inspection or otherwise as to their accuracy. No person in this firm's employment has the authority to make or give any representation or warranty in respect of the property.

Area Map



Energy Efficiency Graph

